

# MV Thai Sea

1-12 person



Bunk Bed



Master Double



Sun Deck

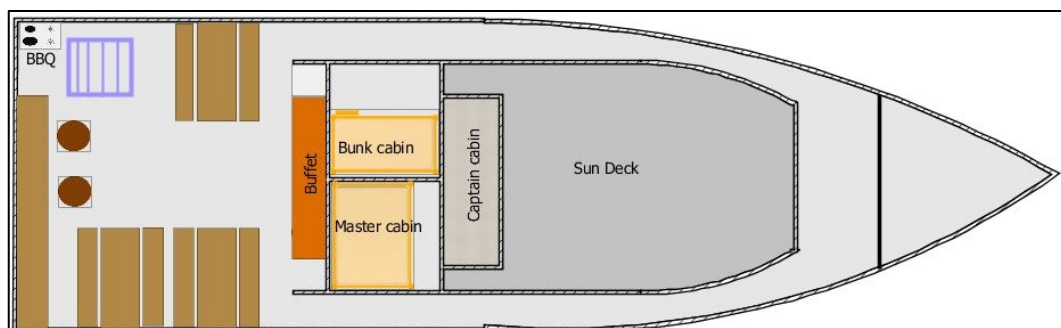
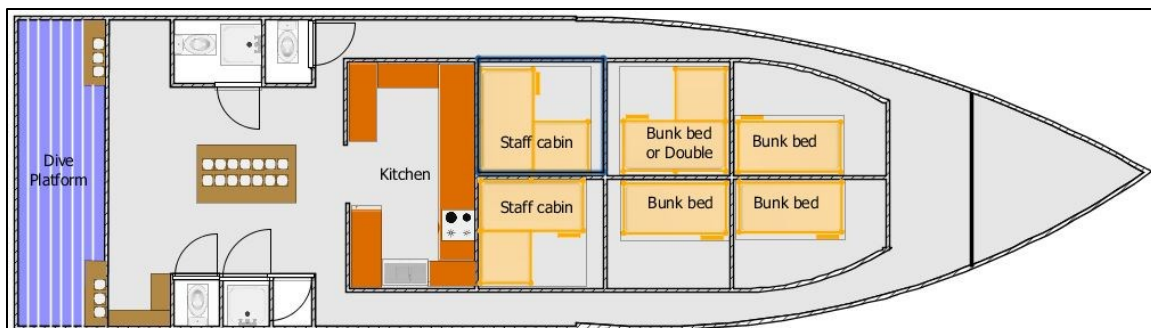



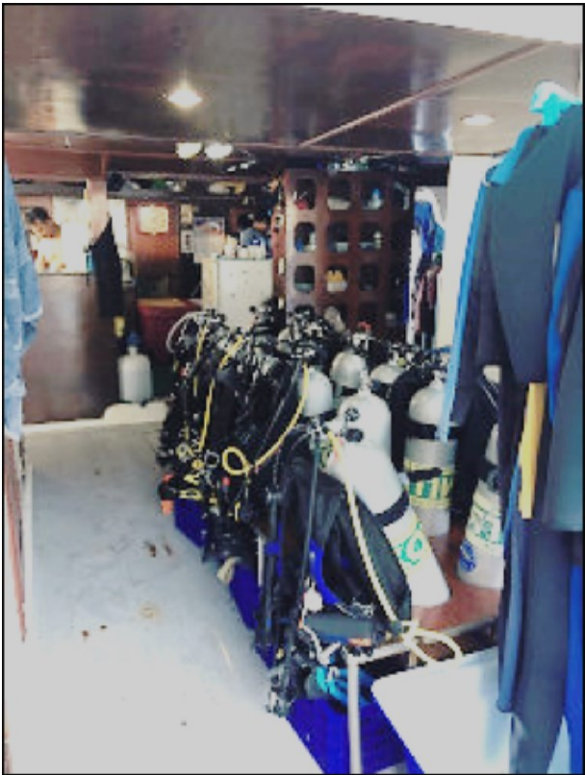

# Boat Specifications

1-12 person

<b>Boat type</b>	Motor Vessel
<b>Length</b>	20 m
<b>Width</b>	5 m
<b>Engine</b>	Hine 260 HP
<b>Cruising speed</b>	7 knots
<b>Diesel tank</b>	3000 liters
<b>Fresh water tank</b>	8000 liters

## Electricity

<b>Voltage</b>	220V / 24V
<b>Generator</b>	2 generators

## Diving

<b>Tanks/Nitrox</b>	19 tanks (17x12L tanks and 2x15L tanks)
<b>Nitrox fill station</b>	Yes
<b>Air compressors</b>	2 x Bauer
<b>Dinghy</b>	310 hypalon, Yamaha outboard 15HP 1 guide for 4 divers

## Ratio guide to divers

## Cabin and Crew

<b>Max guest</b>	12 guests
<b>Cabins</b>	1 Master double bed cabin, 5 bunk beds cabin; Shared bathroom; Hot showers
<b>Crew</b>	4 x boat crew & 3 dive guides for 12 guests

## Navigation & Communication

Fish finder/sounder, GPS and Navionics navigation system, normal radio and VHF radio (Nautilus marine radio with emergency calling system with integrated GPS sending our location to all around), satellite phone

## Safety

First Aid Kit, Life Jackets, Bilge pump alarm, Searchlight and loudhailer, Emergency lights, signal devices, Fire extinguishers, 90.000 liters of continuous-flow oxygen on board as well as on demand delivery system, Non-Rebreather- & Pocket Mask with O2 feed, Oxygen provider trained instructors, EFR, CPR and care for children instructor. Life raft 25 people

## Other Special / Facility

Photograph corner and charging docks. Like Thailand 220 V on all outlets EU 2 pin plugs.